

1/2" FIXTURING PINS

S1933 | S1934
Round Pin | Diamond Pin

PRODUCT DIMENSIONS

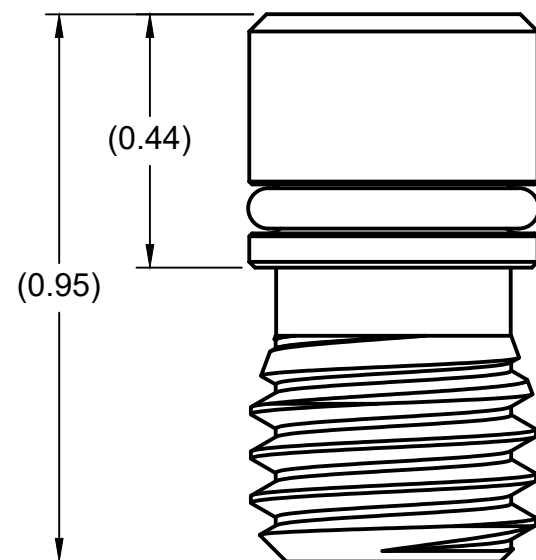
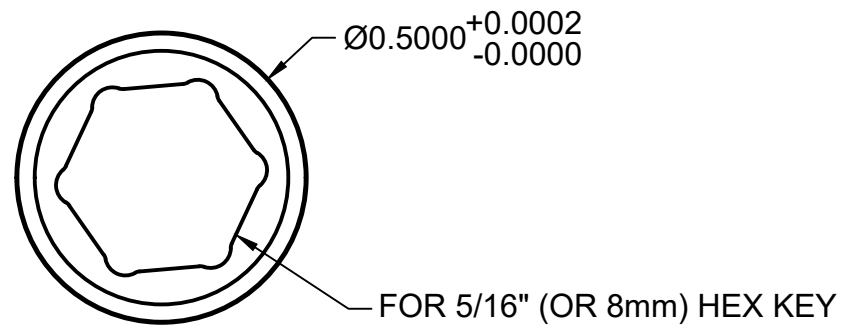

RECOMMENDED BORE SPECIFICATIONS

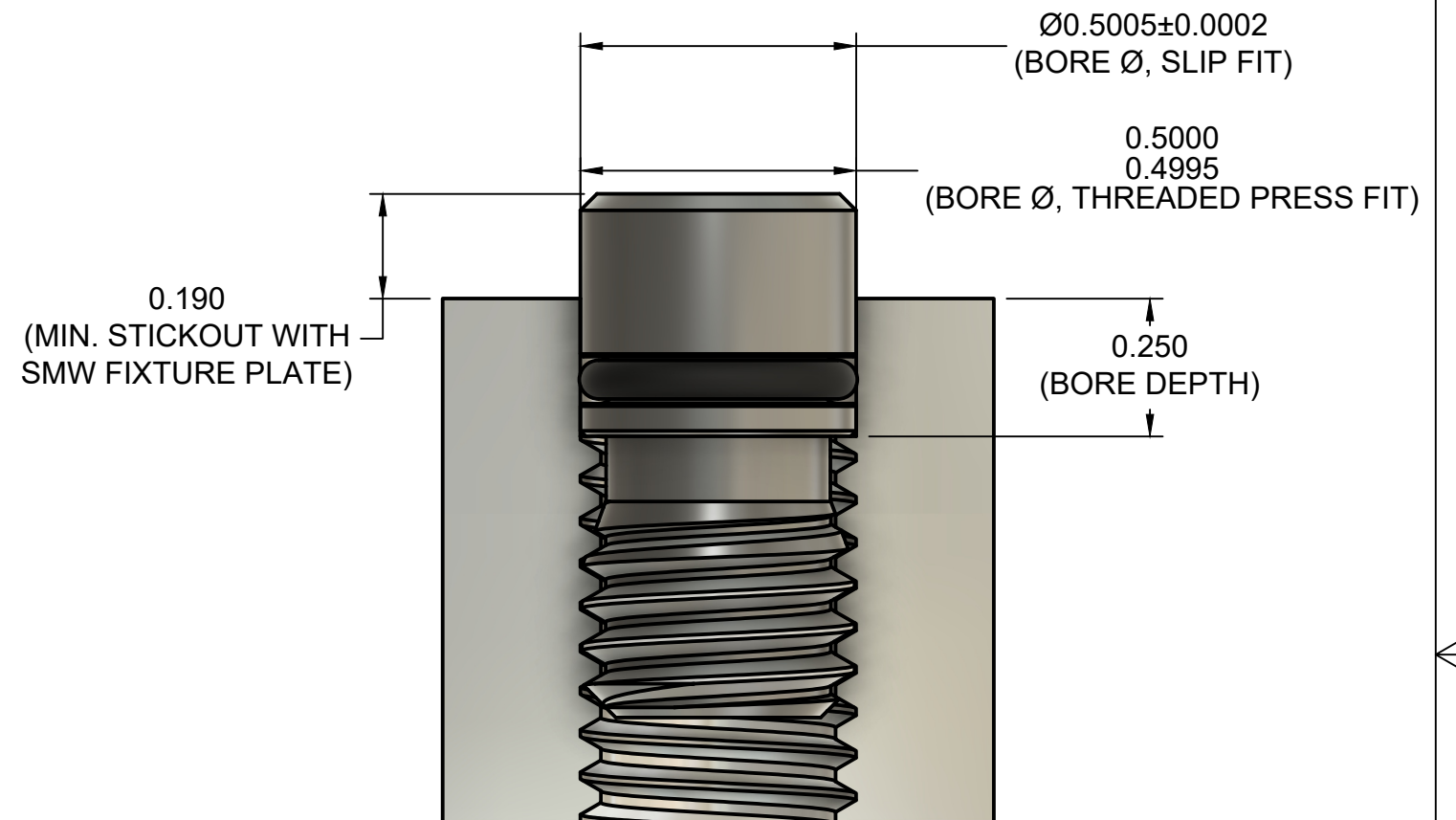

PROPER DIAMOND ORIENTATION

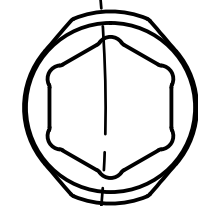
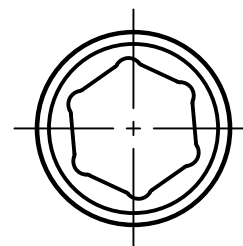

When using both round and diamond pins, ensure that the 'points' of the diamond pin fall on the circumference of a circle drawn from the center of the round pin. This allows the diamond pin to provide proper angular location while giving clearance for ease of assembly/removal. Diamond pins should NOT be fully tightened (allowing for proper orientation)

ALL DIMENSIONS IN INCHES (UNLESS OTHERWISE SPECIFIED).